



## Compact 5 Track Chair

FERNO/MAN/0721/212-R2/UK  
Stock Code 2003-0144



*Read this Manual  
and Retain for  
Future Reference*

## Ferno UK Customer Services

Customer Service and product support are important aspects of each Ferno product. Please have the product serial number available when calling, and include it in all written communications.

Telephone - Main Reception	+44 (0) 1274 851999
Telephone - Sales Department	+44 (0) 1274 854510
Telephone - Service Department	+44 (0) 1274 854511
Email - Sales	sales@ferno.co.uk
Email - Service	services@ferno.co.uk
Web	www.ferno.co.uk

Ferno (UK) Ltd, Ferno House, Stubs Beck Lane, Cleckheaton,  
West Yorkshire, BD19 4TZ

### ALL OTHER LOCATIONS

For assistance or information, please contact your Ferno distributor. If you do not have a Ferno distributor, please contact your nearest Ferno Customer Services office.

### USA HEADQUARTERS

Ferno-Washington, Inc., 70 Weil Way  
Wilmington, Ohio 45177-9371, U.S.A.

Telephone	Country Code +1.937.382.1451
Fax	Country Code +1.937.382.6569
Internet	www.ferno.com

## Disclaimer

This manual contains general instructions for the use, operation and care of this product. The instructions are not all-inclusive. Safe and proper use of this product is solely at the discretion of the user. Safety information is included as a service to the user. All other safety measures taken by the user should be within and under consideration of applicable regulations. It is recommended that training on the proper use of this product be provided before using this product in service.

Retain this manual for future reference. Include it with the product in the event of transfer to new users. Additional free copies are available upon request from Ferno Customer Service.

## Proprietary Notice

The information disclosed in this manual is the property of Ferno UK. Ferno UK reserves all patent rights, proprietary design rights, manufacturing rights, reproduction use rights, and sales use rights thereto, and to any article disclosed therein except to the extent those rights are expressly granted to others or where not applicable to supplier proprietary parts.

## Limited Warranty Statement

The products sold by Ferno UK are covered by a limited warranty. The complete terms and conditions of the limited warranty, and the limitations of liability and disclaimers, are also available upon request by calling Ferno UK on +44 (0) 1274 851999.



Chair/Track Serial Numbers: \_\_\_\_\_

Location: on wheel axle, at base of chair



FERNO S.r.l.  
via B. Zallone, n. 26, 40066  
Pieve di Cento, Bologna, Italy  
+39.051.6860028



Ferno (UK) Ltd.  
Ferno House, Stubs Beck Lane  
Cleckheaton, West Yorkshire, BD19 4TZ  
+44 (0) 1274 851999





**USERS' MANUAL**

To request additional free users' manuals, contact Ferno UK Customer Service, your Ferno distributor, or visit [www.ferno.co.uk](http://www.ferno.co.uk).

## TABLE OF CONTENTS

Section	Page	Section	Page
		<b>Illustrations</b>	
Ferno Contact information _____	2	Figure 1 - Front view with arm rests in down position _____	5
<b>1 - Safety Information _____</b>	<b>4</b>	Figure 2 - Rear view with arm rests in down position _____	5
1.0 Warning _____	4	Figure 3 - Side view with extended track and foot plate _____	7
1.1 Important _____	4	Figure 4- Unfolding the chair for use _____	8
1.2 Caution _____	4	Figure 5 - Release locking bar _____	8
1.3 Safety and Instruction Labels _____	5	Figure 6 - Pull red release/locking knob to raise/lower handle _____	8
1.4 Symbol Glossary _____	5	Figure 7 - Pull handle up-wards to raise _____	8
<b>2 - Operator Skills and Training _____</b>	<b>6</b>	Figure 8 - Pull down foot plate _____	9
2.0 Intended Use _____	6	Figure 9 - Feet positioning on foot plate _____	9
2.1 Skills _____	6	Figure 10 - Red handle for track deployment _____	9
2.2 Training _____	6	Figure 11 - Ensuring tack is fully deployed _____	9
2.3 Safety Precautions _____	6	Figure 12- Push red handle to retract the track using right foot _____	9
<b>3 - About the Chair _____</b>	<b>7</b>	Figure 13 - Ensuring the track is fully retracted _____	9
3.0 General Specifications _____	7	Figure 14- Folding position _____	10
<b>4 - Quick Set-Up Guide _____</b>	<b>8</b>	Figure 15 - Pull bar to fold chair _____	10
4.0 Unfolding the Chair _____	8	Figure 16 - Lock wheels for stowage _____	10
4.1 Folding and unfolding the Track _____	9	Figure 17- Telescopic handle release button _____	10
4.2 Folding the Chair _____	10	Figure 18 - Extending the telescopic handle _____	11
4.3 Telescopic Carry Handles _____	10	Figure 19 - Engaging wheel break _____	12
<b>5 - Using the Chair _____</b>	<b>11</b>	Figure 20 - Red track closing handle _____	13
5.0 Checking the Compact 5 Track _____	13	Figure 21 -Operator Diagram 1 _____	14
5.1 Folding and unfolding the Chair _____	11	Figure 22 - Operator Diagram 2 _____	15
5.2 Height positional upper handle _____	11	Figure 23- Lubricating points 1 _____	19
5.3 Extending carrying handles _____	11	Figure 24 - Lubricating points 2 _____	19
5.4 Patient restraints _____	12		
5.5 Folding foot plate _____	12		
5.6 Compact 5 Track Chair wheels _____	12		
5.7 Use of Track on Chair _____	13		
<b>6 - Operating Procedure Guidelines _____</b>	<b>14</b>		
6.0 General usage information _____	14-16		
6.1 Moving the chair _____	16		
6.2 Using the chair in ground level _____	16		
6.3 Gliding the Chair down stairs _____	16		
6.4 Using the chair up-stairs _____	17		
<b>7 - Wall Mounting Bracket _____</b>	<b>18</b>		
7.0 Using the Wall Bracket _____	18		
<b>8 - Care of the Compact 5 Track Chair _____</b>	<b>18</b>		
8.0 Maintenance _____	18		
8.1 Disinfection & Cleaning _____	18		
8.2 Lubricating the chair _____	19		
8.4 Inspecting the chair _____	20		
<b>9 - Service Support &amp; Warranty _____</b>	<b>21</b>		
9.0 UK Service Support _____	21		
9.1 Worldwide _____	21		
9.2 Terms and Conditions _____	21		
9.3 Service Maintenance History _____	21		

# 1 - SAFETY INFORMATION

## 1.0 Warning

Warning notices indicate a potentially hazardous situation which, if not avoided, could result in injury or death.

 <b>WARNING</b>
<p><b>Improper use of the chair can cause injury. Use the chair only for the purpose described in this manual.</b></p> <p><b>Untrained operators can cause injury or be injured. Permit only trained personnel to operate the chair.</b></p> <p><b>Improper operation can cause injury. Operate the chair only as described in this manual.</b></p> <p><b>An unattended patient can be injured. Stay with the patient at all times.</b></p> <p><b>An unrestrained patient can fall off the chair and be injured. Use restraints to secure the patient on the chair.</b></p> <p><b>Helpers can cause injury or be injured. Maintain control of the chair, whilst directing all helpers.</b></p> <p><b>Improper maintenance can cause injury. Maintain the chair only as described in this manual.</b></p> <p><b>Non Ferno parts and service can cause injury. Use only Ferno parts and Ferno approved service on the chair.</b></p> <p><b>Modifying the chair can cause injury and damage. Use the chair only as designed by Ferno.</b></p> <p><b>Attaching Non Ferno items to the chair can cause injury. Use only Ferno approved items on the chair.</b></p>

 <b>WARNING</b>
<p><b>It is recommended NOT to carry occupant with the rear handle FULLY EXTENDED.</b></p> <p><b>The upper handle is to be used for descending stairs only at the maximum extended position.</b></p>

## 1.1 Important

### Blood borne Disease Notice

To reduce the risk of exposure to blood borne diseases such as HIV-1 and hepatitis when using the chair, follow the disinfecting and cleaning instructions in this manual.

## 1.2 Caution

Bleach, phenols and iodine can cause damage. Do not apply products containing these chemicals to the Chair.

Improper lubricants can cause damage. Use a liquid lubricant oil such as "3-IN-ONE Multi-purpose drip oil" to lubricate the Chair where specified.

Trapping hazards are unavoidable in the design of this equipment due to its folding action. Operate the folding mechanism with care.

 <b>WARNING</b>
<p><b>Do NOT exceed the safe working load of 200 kg</b></p>

### 1.3 Safety and Instruction Labels

Safety and instruction labels place important information from the users' manual on the Chair.

Read and follow label instructions. Replace worn or damaged labels immediately. Replacement labels are available from Ferno UK.

### 1.4 Symbol Glossary

The symbols defined to the right are used on the Chair and/or in this users' manual. Ferno uses symbols recognised by the International Standards Organisation (ISO).



Do Not Lubricate



Safe Working Load



Product meets UK and EU Standards



Instruction:  
Closing Track

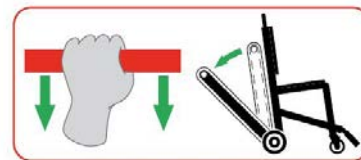

Instruction;  
Opening Track



Figure 1 - Front view with armrests in down position



Figure 2 - Rear view with track deployed and armrests in down position

## 2 - OPERATOR SKILLS AND TRAINING

### 2.0 Intended Use

For the purpose of this manual, the Compact 5 Track Chair will be referred to as the Chair and the person being transported on the Chair will be referred to as the patient. The Chair is a handling device designed to transport a patient, in a seated position, on stairs and level ground. The Chair will glide smoothly down a wide range of stair types and can quickly return to a four wheel chair at the end of a run of stairs. When on two or four wheels it can rotate within its own length making it ideal for half landings and similar restricted areas. Where conditions require, the chair may also be carried using the anti-slip handle grip areas.

### 2.1 Skills

Operators using the chair need:

- The strength, balance, coordination and common sense to safely operate the Chair.
- The ability to select the proper equipment and procedures for the circumstances.
- Operators should have been trained in the operation of the Chair.
- The ability to understand and follow the procedures described in this manual.
- Operators should have a working knowledge of manual handling procedures.

### 2.2 Training

Operator trainees need to:

- Have followed a training plan.
- Read and understand the instructions in this manual.
- Practice using the fully-equipped Chair with weight and under simulated conditions.
- Trainees should be tested to verify their understanding of Chair operation.
- Keep training records. Annual refresher training for all Chair operators is recommended.

### 2.3 Safety Precautions

To ensure safety and satisfaction with your new Chair, all users should read these instructions and the individual portions of recognised emergency care manuals that relate to the application and use of Chair. It is recommended that a minimum of two trained operators control a loaded Chair on stairs, they should assess whether additional assistance is required.



#### WARNING

**Untrained operators can cause injury or be injured.  
Permit only trained personnel to operate the Chair.**



#### WARNING

**Improper use of the Chair can cause injury. Use the  
Chair only for the purpose described in this manual.**



## 3 - ABOUT THE CHAIR

### 3.0 General Specifications

Most general specifications below are rounded to the nearest whole number. For more information, contact Ferno Customer Service (page 2).

Ferno reserves the right to change specifications without notice.

The Compact 5 Track is a carry chair with the capability of deploying a track module to assist in the descent of stairs where it is deemed appropriate by the operators to use as a tracked chair.



Figure 3 - Side view, extended tracks and foot plate

#### CHAIR FEATURES

- Chair folds to minimise stowage space.
- Track can be extended for descending stairs.
- Adjustable handle to enable correct posture for operator.
- Anti-Bacterial properties within Restraints, Grip Tape, and Seat Cover.

<b>Chair height from floor (folded)</b>	<b>1150 mm</b>
<b>Chair height</b>	<b>1130 mm</b>
<b>Height with rear handle extended</b>	<b>1600 mm</b>
<b>Seat height</b>	<b>510 mm</b>
<b>Seat width</b>	<b>380 mm</b>
<b>Seat depth</b>	<b>385 mm</b>
<b>Width (widest point)</b>	<b>435 mm</b>
<b>Weight of carry chair</b>	<b>16.4 kg</b>
<b>SWL / Max load capacity</b>	<b>200 kg</b>
<b>Strap type</b>	<b>Biosafe</b>
<b>Strap length – Chest</b>	<b>1650 mm</b>
<b>Strap length – Waist</b>	<b>1650 mm</b>
<b>Strap length – Leg</b>	<b>1200 mm</b>

- All dimensions are approximate
- Operators must consider the weight of the patient and accessories when determining total load on the Chair

## 4 - QUICK SET-UP GUIDE

### 4.0 Unfolding the Chair

For the purpose of this guide, the Compact 5 Track Chair will be referred to as the Chair and the person being transported on the Chair will be referred to as the patient.

The Chair will normally be left in the folded condition and the first task will be to unfold and make the Chair safe for transporting a patient.



Figure 4 - Unfolding the Chair for use

1. Unbuckle the chest strap securing the chair and fold the chair out into the seated position



Figure 5 - Release locking Bar

2. Just below the seat there is a bar that automatically locks the chair in to the seated position, ensure this is engaged and secure before seating the patient in the chair. (See fig 5)

**DO NOT PULL DOWN THE FOOT PLATE UNTIL PATIENT IS SEATED.**

3. The chair is fitted with an adjustable height handle. To raise or lower the handle to the required position pull red release knob on the back of the chair to release the locking pin whilst raising or lowering the handle to the required height.



Figure 6 - Pull red release/locking knob to raise and lower handle



Figure 7 - Lift handle upwards to desired position with other hand



## 4 - QUICK SET-UP GUIDE

### 4.0 Unfolding the Chair (cont.)

4. Once the patient has been seated comfortably in the chair pull down the foot rest and place their feet on to it. Fasten all restraining straps to secure the patient



Figure 8 - Pull down foot plate



Figure 9 - Feet positioning on foot plate

### 4.1 Folding and Unfolding Track

The track aids descent on stairs, do not unfold the track if the chair is not needed to descend stairs.

5. To unfold the track from the rear of chair pull the central red bar towards you until the track locks into position.



Figure 10 - Red handle for track deployment



Figure 11 - Ensuring the track is fully deployed

6. To fold the track into the back of the chair push the retract lever downwards as shown, until track is flush with the back of the chair and locks in to position, using either your foot or hand.



Figure 12 - Push red handle to retract the track using right foot



Figure 13 - Ensuring the track is fully retracted

## 4 - QUICK SET-UP GUIDE

### 4.2 Folding the Chair

Before folding the chair for storage ensure that the foot rest and armrests are in the up position and that all handles are not extended.



Figure 14 - Folding position

1. Foot rest and arm rest in up position and handles retracted.

2. Squeeze the bar as shown in Fig 15, and collapse chair in to folded position. Use the chest restraint to wrap around the chair to keep folded.



Figure 15 - Pull bar to fold chair



Figure 16 - Lock wheels for stowage

### 4.3 Telescopic Foot-end Carry Handles

The chair is fitted with telescopic carrying handles at the foot-end to aid transporting the chair down stairs using the tracks. To change position of the handles press button (See fig 17) and pull/push handles to extend or shorten.



Figure 17 - Telescopic handle release button



Figure 18 - Pull telescopic handle to extend

## 5 - COMPACT 5 TRACK CHAIR OPERATION

(Refer to pages 8, 9 & 10 for the Quick Set-up Guide)

### 5.0 Checking the Compact 5 Track

The following checks are required each day before the use of the Chair:

- Overall cleanliness of the Chair.
- Check that there are no bent or damaged parts, missing fasteners, etc.
- Check that the wheels rotate freely with no excess movement or damage.
- Check that the Chair unfolds and locks securely in the seating position for normal use.
- Check that the track system opens and closes correctly, examine the tracks for damage.
- Check the upholstery for cracks, splits or any loose fabric or stitching, etc.
- Check that the upholstery is correctly secured to the frame.
- Check that all restraints are present and functioning correctly.

**If in any doubt then contact a Ferno Service Engineer.**

**Regular cleaning helps reduce the risk of transmitting disease and enables the equipment to function at its optimum.**

### 5.1 Folding and Unfolding the Chair

The Chair folds for shipping and stowage.

#### To Unfold

1. Release the chest strap from the Chair and allow the chair to fold down into the seated position.
2. Completely unfold the Chair by firmly pushing up the back until an audible click is heard, this is the locking bar engaging into the locking catches, visually confirm this.

#### To Fold

When folding the chair ensure the following procedure is carried out.

1. Fully lower the head-end adjustable handle (see fig.7)
2. Check that the carrying handles at the front of the chair are not extended.
3. Ensure foot rest is folded up.
4. Ensure the track is folded flush with the back of chair.
5. To release the chair for folding pull the locking bar at front of the chair and fold the Chair forwards until it is flat.
6. Stand the chair upright on the back wheels.
7. The Chair chest strap can be used to secure the Chair in the closed position.

### 5.2 Height Positional Head-End Adjustable Handle

1. The head-end handle can be locked into three different positions to assist operations on stairs and also to allow for height variations of operator.
2. To adjust the upper handle into alternative positions, pull the locking pin knob on the back of the chair to release the locking pins whilst maintaining a grip on the adjustable upper handle. Lift or lower the handle and release the knob at the desired height ensuring the locking pin is located in a hole and locked in place.

### 5.3 Foot-end Extending Carrying Handles

1. The telescopic carrying handles are located at the front of the chair just above the castor wheels and are to be used in conjunction with the chair track. When using the Track, extend the handles to suit the height of the operator.
2. The handles are easily extended or shortened by pressing down on the buttons located on the handles with the thumb and pulling or pushing the handles to extend or shorten. Ensure the handles are locked before attempting to move the chair.

### 5.4 Patient Restraints

Use the chest, waist and foot restraints to secure patient into the Chair. Assess patient condition to determine optimum strapping procedure.

- **Chest Restraint** - The chest restraint is also used to secure the chair closed for stowage. Fasten the chest restraint using plastic male/female buckle system. Pull at either side of the buckle to tighten the restraint.
- **Waist Restraint** - The waist restraint is for extra security and comfort for the patient. Fasten the waist restraint using plastic male/female buckle system. Pull at either side of the buckle to tighten the restraint.
- **Foot Restraint** - Once the patient's feet are comfortably placed on the integral footrest, the loose foot restraint can be fastened to secure the feet. Fasten foot strap using plastic male/female buckle system. Pull at either side of the buckle to tighten the restraint. Remember that the foot restraint also protects the operator when moving the Chair on stairs.
- **Releasing Restraints** - To release foot and lap restraints, squeeze the two sides of the tang on the buckle inward at the same time and pull the buckle apart.

### 5.5 Folding Foot Plate

Please note: The foot plate must not be deployed until the patient is in a comfortable seated position as the chair may tip forwards if the foot plate is used as a platform by the patient when being seated

- **To Fold Foot Rest** – Simply push the foot plate up against the chair.
- **To Unfold Foot Rest** – Pull the foot plate downwards into the correct position.

### 5.6 Compact 5 Track Chair Wheels

The Chair is fitted with two large braked wheels to the rear and twin wheeled castors at the front of the chair below the foot plate.

- The Chair may be wheeled using all four wheels where the front swivel castors provide excellent manoeuvrability, alternatively, should conditions require, the chair may be tilted back and run on the two larger wheels. *ALWAYS inform the patient of your intentions.*
- To apply the brakes on the rear wheels, press the brake pedal down. To release the brake push the lever on the top of the wheel forward with your.



Figure 19 - Engaging wheel break

#### **WARNING**

**Only fully raise the handle when using the Chair to descend stairs with the Track deployed.**

## 5.8 Use of Track on Chair

In addition to the wheels the Chair is fitted with a track system to allow the operators to glide the chair down stairs instead of lifting and carrying.

### Guidelines for using the track system

- Using the Chair on stairs requires a minimum of two trained operators. Ferno recommends using a third person as a "spotter" (see, using the Chair on Stairs), wherever possible.
- Verify that the track is fully opened and locked into place before using it.
- Verify that the telescopic handles are extended and locked before lifting.
- Never lubricate track belts. Lubricated track belts can perform unpredictably, resulting in injury to the patient and/or operators.
- Moisture, water, snow, ice or debris on or between the track and belts can cause irregular track-belt performance that results in sudden changes in the weight operators must support. Make sure the track and track belts are clean and dry before using the Chair on stairs.
- Always clear stairs of debris etc., which could interfere with the operation of the Chair or impede the operators.

### Opening the Track

1. Grasp the top of the chair with one hand and with the other grasp the track release bar (red labelled) located near the top of the tracks and firmly pull it back until the track locks into the fully extended position. (See fig. 10)
2. Verify that the lock is engaged by trying to push the track closed. If the lock is fully engaged the track will not fold back.

### Closing the Track

1. With one hand, grasp the track release bar (red labelled) located near the top of the tracks and with the other hand push down on the track closing handle located on the right side of the tracks. Pushing the track closed with the track release bar will assist this action. The track closing handle can also be operated using your foot to push down on the handle, instead of pushing with your hand. (See image below or 4.2)

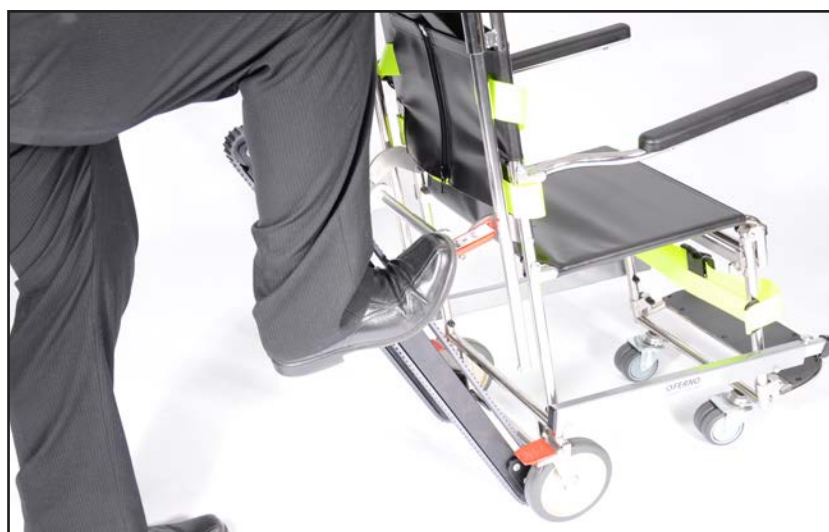

Figure 20 - Red track closing handle



## 6 - OPERATING PROCEDURE GUIDELINES

### 6.0 General Information

#### IMPORTANT

Always inform the patient before a manoeuvre.

#### IMPORTANT

Chair operation requires a minimum of:

- Two trained operators when the Chair is being used to transport a patient on stairs.
- One operator only, can safely use the Chair on flat surfaces including single steps, thresholds etc, however this must be at the discretion of the operator who must assess all likely conditions.
- One operator can safely load/unload a patient using the Chair from a vehicle fitted with a ramp, automatic tail-lift or other approved mechanical lifting mechanism.
- Circumstance such as access, weather conditions or patient weight may require additional help when operating on stairs; this must be assessed at the time. However the following is a suggested configuration.

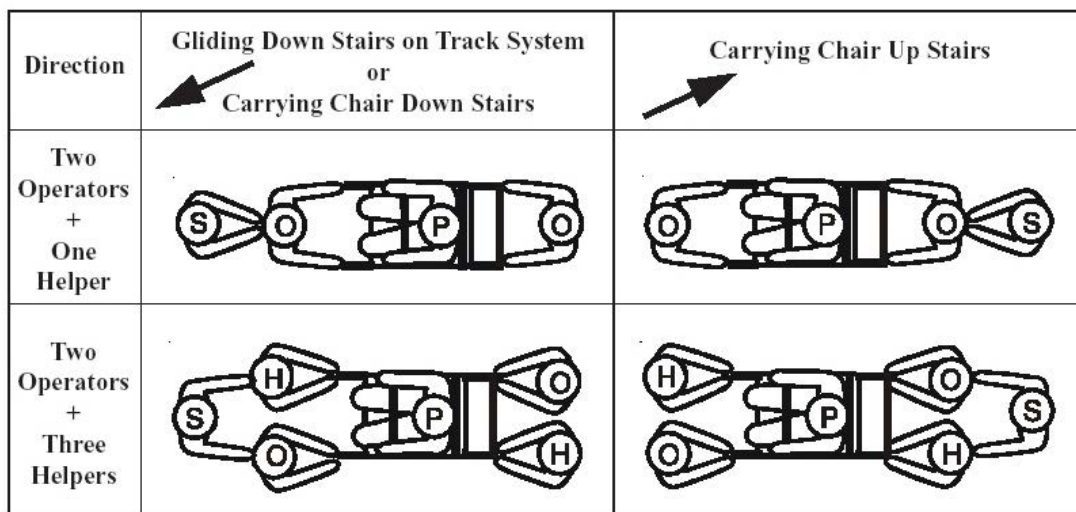

Key: O = Operator H = Helper S = Spotter P = Patient

Figure 21 - Operator Diagram 1

 <b>WARNING</b>
<b>Improper use can cause injury. Use the Chair only for the purpose described in this manual</b>



## 6 - OPERATING PROCEDURE GUIDELINES

- Placement techniques, heavy patients, rough terrain or unusual circumstances may require more additional help; this must be assessed at the time however the following is a suggested configuration.

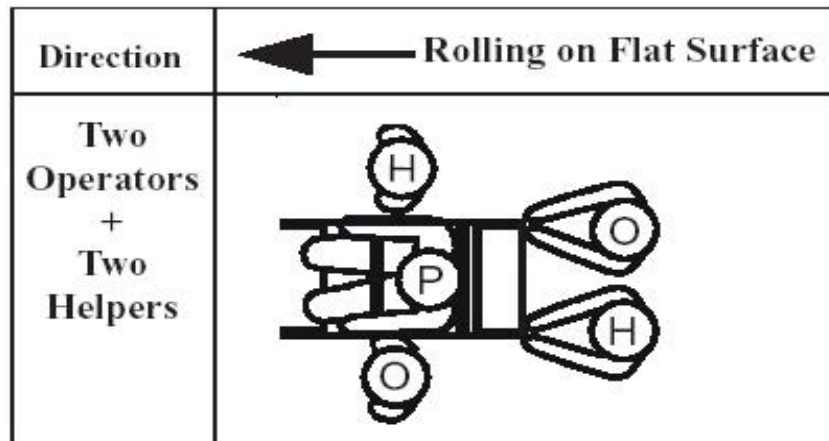
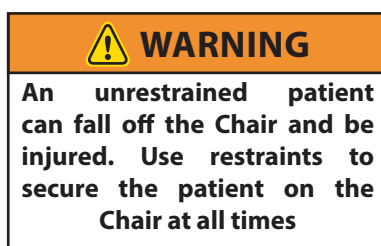

Figure 22 - Operator Diagram 2

- Keep the load limit of the Chair in mind when working with a heavy patient. If it is suspected that the load limit has been exceeded then a full inspection of the Chair should be conducted, preferably by a Ferno Service Technician.
- Operators must take extra precautions when operating the Chair on uneven ground.
- Extra precautions should be taken to prevent the Chair from slipping in adverse, wet or icy weather conditions.
- Stay with the patient at all times and always use the patient restraints provided.
- Always follow good lifting procedures as specified in current manual handling regulations and your appropriate training manual.
- Follow standard emergency patient-handling procedures when operating the Chair.
- Medical advice and manual handling protocols are beyond the parameters of the manual. It is the user's responsibility to ensure safe practices for both themselves and the patient.



## 6 - OPERATING PROCEDURE GUIDELINES

### 6.1 Moving the Chair

- Place the patient on the Chair using local protocols for patient handling. Ensure that the patient is seated with their back fully against the back panel and their head securely positioned within the head pad before deploying the patient restraints.
- Chest waist and foot restraints must be applied before moving the Chair.

### 6.2 Using the Chair on Level Ground

- Before rolling the Chair on level ground, the head end operator adjusts the upper handle to the desired position for comfortable use.
- Inform the patient so that they are aware about what is happening.
- Two castor wheels are affixed to the foot end frame. These assist with movement on level ground and mean that the Chair can be used without tilting backwards.
- The operator at the foot end of the Chair assists as required with obstacles like door frames or uneven surfaces. The lower handle can be used to overcome larger obstacles.

### 6.3 Gliding the Chair Down Stairs

- It is strongly recommended that the following procedures be practiced with a chair loaded with dummy weights such as bagged builders sand or gravel.
  - Using the Chair on stairs requires a minimum of two operators. Use additional help as needed to control the Chair (see page 14).
  - It is recommended that the two operators face each other when transporting a patient down stairs. If available a third person should assist by acting as a guide for the foot-end operator.
  - Ensure the route down the stairs is clear of obstructions that could affect the safety of the operators or the function of the tracks.
1. **Head-end operator** – fully extend the upper handle and ensure it is locked. (see page 8).
  2. **Head-end operator** – deploy the track and ensure it is locked (see page 9)
  3. **Foot-end operator** – take up position on the stairs facing the chair and extend the lower foot-end handles and ensure they are locked in place (see page 10)
  4. **Both operators** – working together, guide the Chair over the edge of the top step, allowing the track belts to engage the step.
  5. **Both operators** – move the Chair slowly downwards until the tracks are resting on the top two or three steps. This establishes the glide angle. Ensure both operators are comfortable before proceeding.
  6. To maintain the glide angle –
    - **Head-end operator** – applies slight downward pressure on the extended upper handle holding the chair into the stairs
    - **Foot-end operator** – applies slight downward and forward pressure to the foot-end lift handles holding the chair into the stairs and maintain glide angle.
  7. **Both operators** – when chair reaches the bottom of the steps and rear wheels are on the floor, the foot end operator releases the foot-end handle, the head-end operator tips the Chair forward until all four wheels are on the floor.
  8. If this is the end of the stairs then the Head-end operator can fold the track and lower the upper handle to a comfortable height.

#### TO PAUSE DURING DESCENT

To pause during the descent, tilt the Chair forward just enough to allow the rear wheels to rest on the step while both operators hold the Chair in place.

To continue down the stairs, tilt back the Chair and regain the glide angle (see step 5 above)

## 6 - OPERATING PROCEDURE GUIDELINES

### 6.4 Using the Chair Up-Stairs

Once the patient is seated on the Chair and restrained, adjust the upper handle into a position that is comfortable for your height. (See Section 5.2 on Upper Handle). The upper handle position can be changed to provide a better hand grip.

Note: the cross bar can also be used for lifting.

Always inform the patient about what is happening.

Once the head end and foot end operators are in their correct positions grasping the head-end and foot-end handles, the head end operator leans the Chair backwards until the patient's weight is on the transport wheels.

At this point, the lower handle is more easily accessible to the foot end operator. The Chair can then be rolled backwards towards the foot of the stairs. The operators can then move the Chair, lifting the chair and patient and start to ascend the stairs, always observing local manual handling protocols.

Upon reaching the top of the stairs, carefully lower the wheels to the floor and continue to move the patient to the required destination by wheeling the chair on all four wheels.

 **WARNING**

**Avoid rapid chair repositioning as this may result in patient injury. Support the Chair while adjusting handles.**

 **WARNING**

**Never leave a patient unattended in the Chair and always use restraints.**

 **WARNING**

**When moving patients always inform them of what you are going to do.**

 **WARNING**

**Never fully extend the head-end upper handle to its fullest extension when lifting the chair. Full extension should only be used when descending stairs on the tracks.**

## 7 - WALL MOUNTING BRACKET

### 7.0 Using the Wall Bracket

- Using the Bracket plate as a template, mark the surface where the holes are to be drilled. Taking in to account height of chair.
- Drill the holes, using the appropriate size drill bit to suit your fittings.
- Once the wall plugs have been fitted into the drilled holes fit the bracket plate (using the appropriate length screws) then tighten screws appropriately.
- Place the folded chair, with track strapped to chair and track on the floor against the wall.
- Feed strap from wall bracket around chair foot rest and tighten to secure chair.
- Cover the chair with dust cover (optional)
- **ENSURE STAFF ARE TRAINED IN THE USE OF THE CHAIR.**

## 8 - CARE OF THE COMPACT 5 TRACK CHAIR

### 8.0 Maintenance

The Chair requires regular inspection. Set up and follow a maintenance schedule. The table to the right represents minimum intervals for maintenance. Ferno recommend to lubricate every 3 months and/or after a deep clean.

#### Keep maintenance records.

When using maintenance products, follow the manufacturer's directions and read the manufacturer's material safety data sheets.

Alternatively the Chair can be inspected in line with the Ambulance maintenance schedule.

Further details on maintenance are available from Ferno UK Service Department or through approved service technicians.

Recommended Maintenance Intervals	Each Use	As Needed	3 Months
Disinfecting	•		
Cleaning		•	
Inspecting	•	•	•
Lubricating			•

 **WARNING**  
**Improper maintenance can cause injury. Maintain the Chair only as described in this manual.**

### 8.1 Disinfection & Cleaning

Wipe all surfaces with disinfectant. Follow the disinfectant manufacturer's instructions for application method and contact time. Ferno recommends you inspect the Chair for damage as you clean and disinfect it.

1. Remove the chest restraint, Track and any accessories.
2. Hand clean all surfaces of the Chair with warm water and a mild detergent.
3. Rinse with warm, clear water. Dry the Chair with a towel and allow it to air-dry thoroughly prior to storage.
4. To disinfect: Apply disinfectant to the Chair, following the disinfectant manufacturer's instructions for application method and contact time.

 **WARNING**  
**Disinfectants and cleaners containing bleach, phenolics, or iodides can cause damage. Do not use products containing these chemicals.**

## 8 - CARE OF THE COMPACT 5 TRACK CHAIR

### 8.2 Lubricating the Chair

Disinfect and clean the Chair before applying lubricant. Use the lubricants designated below to lubricate the Chair. Do not lubricate points marked with the "do not lubricate" symbol.

#### LUBRICATION POINTS

Use a small amount of lubricant. Lubricate identical points on each side of the Chair. (See blue arrow)

- |    |                       |   |
|----|-----------------------|---|
| 1. | Push-to-close Latches | Liquid lubricant oil such as " 3-IN-ONE Multi-purpose drip oil" |
| 2. | Locking Bar           | Liquid lubricant oil such as " 3-IN-ONE Multi-purpose drip oil" |
| 3. | Hinge Points          | Liquid lubricant oil such as " 3-IN-ONE Multi-purpose drip oil" |

**DO NOT LUBRICATE THE TRACK** (See Red Arrows)



**Do Not Lubricate**



**Lubricate**



Figure 23 - Lubricating Points 1



Figure 24 - Lubricating Points 2

#### **WARNING**

**Modifying the Chair can cause injury and damage.  
Use the Chair only as designed by Ferno.**

## 8 - CARE OF THE COMPACT 5 TRACK CHAIR

### 8.4 Inspecting the Chair

Have your service's equipment maintenance technicians inspect the Chair regularly. Follow the checklist below and operate the Chair through all its functions as described in this manual.

If inspection shows damage or excessive wear, remove the Chair from service until repair is made.

#### IMPORTANT

Water under high pressure, or steam, can penetrate joints, flush away lubricant, and cause corrosion. Use caution when cleaning moving parts such as joints and hinges, and reapply lubricant if needed (see right).

#### IMPORTANT

Using abrasive cleaning compounds or applicators on the Chair can cause damage. Do not use abrasive materials to clean the Chair.

#### IMPORTANT

Lubricating parts that should not be lubricated allows dirt and foreign particles to collect on those parts, resulting in damage.

#### INSPECTION CHECKLIST

- Are all components present?
- Is the Chair and Track free of excessive wear?
- Are all screws, nuts, bolts, rivets, and roll pins securely in place?
- Do all moving parts operate smoothly and properly?
- Does the Chair lock properly into each position?
- Does the safety hook engage the safety bar?
- Does the Chair roll smoothly?
- Do the wheels have adequate tread?
- Are the restraints properly installed?
- Is restraint webbing in good condition with no cuts or frayed edges?
- Are restraint buckles free of visible damage and do they operate properly?
- Do the Track operate properly without interfering with Chair operation?



#### WARNING

**Do NOT lubricate the track belts. Doing so will result in a loss of friction, causing danger to the operator and occupant when descending stairs.**



